

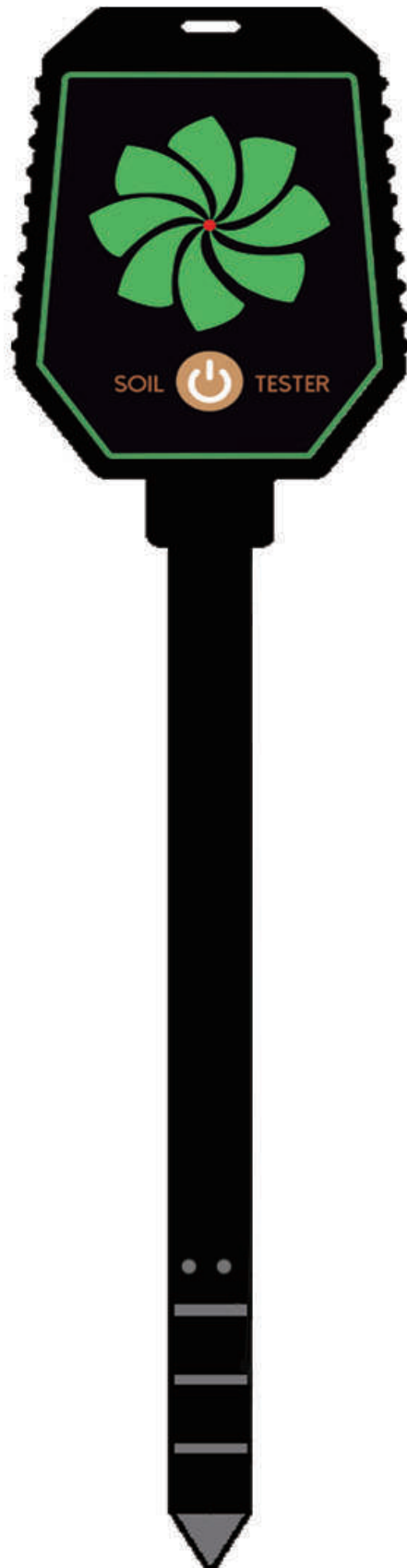







INSTRUCTION MANUAL



8-in-1 Soil Meter

PARAMETER

pH	Range	0.0-14.0pH
	Resolution	0.1pH
	Accuracy	±0.1pH
	Calibration	7.0,4.0,10.0
EC	Range	0.01-9.99mS/cm
	Resolution	0.01mS/cm
	Accuracy	±0.01mS/cm
	Calibration	1413µS/cm
SALT	Range	0-5110mg/L
	Resolution	1mg/L
	Accuracy	±2%F.S.
Fertility	Range	0-99%
	Resolution	1%
	Accuracy	±2%F.S.
Air Humidity	Range	0-100%RH
	Resolution	1%RH
	Accuracy	±2%RH/Year
Temperature	Range	0.0-50.0°C /32.0-122.0°F
	Resolution	0.1°C/0.1°F
	Accuracy	±0.5°C/±0.1°F
Light Intensity	Dark	
	Normal	
	Bright	
Soil Moist	Dry	
	Normal	
	Wet	
	Wet+	

PRODUCT INTRODUCTION

LIGHT RECEIVER SENSOR

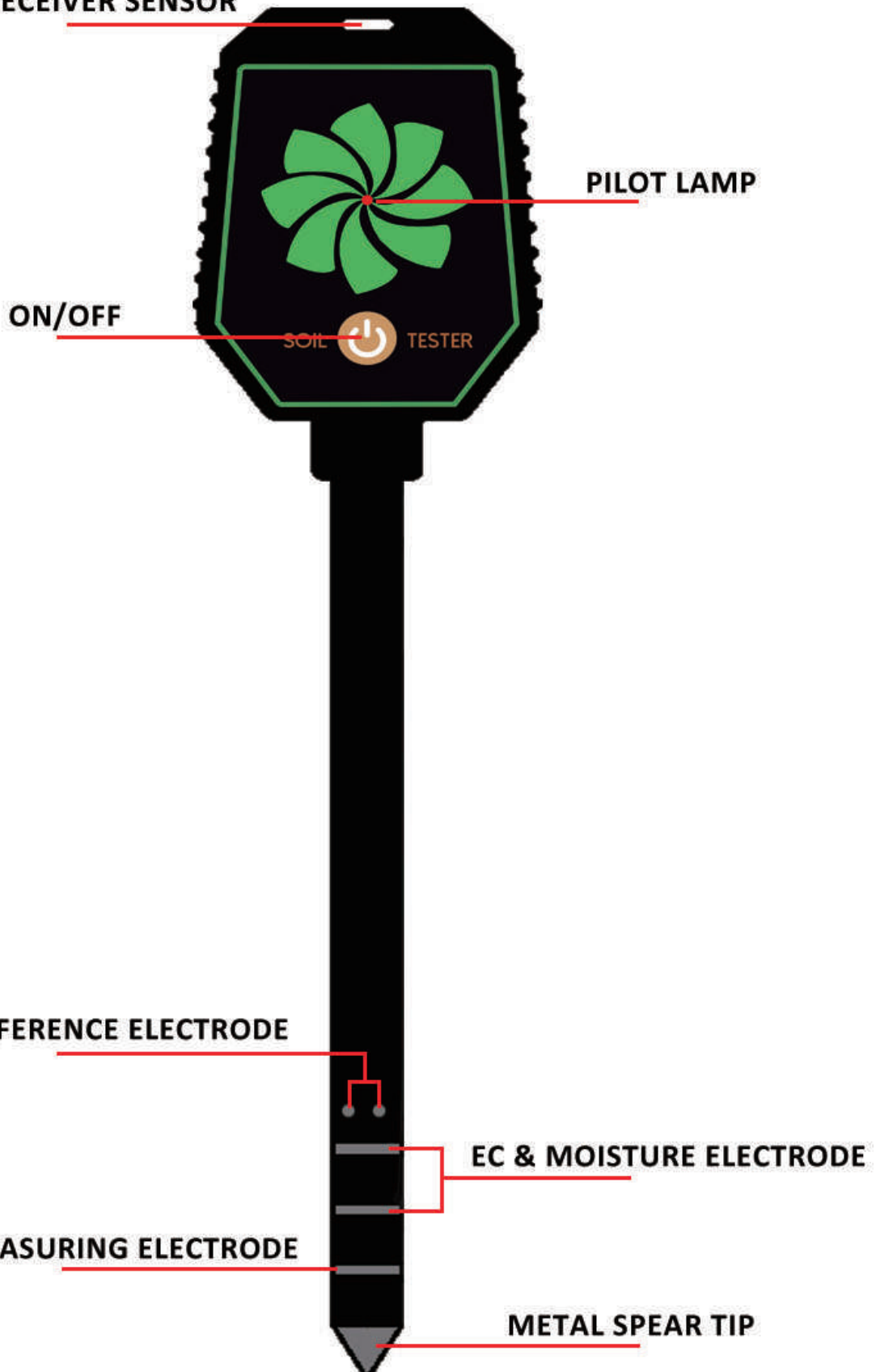

DOWNLOAD THE APP

Use your smartphone to scan QR code, or search "yinmik" app in Google Play Store or APP Store to download and install.



YINMIK



(IOS)



(Android)

For the first time using the app, please follow the system prompts to enable Bluetooth and location permissions.

Android:

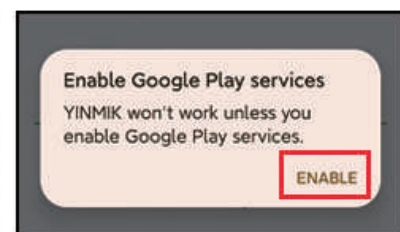
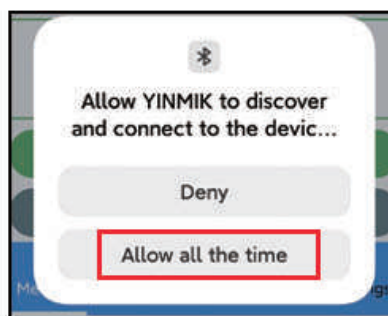
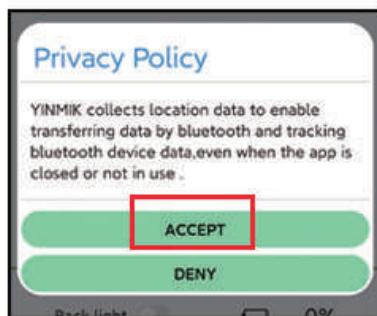

IOS:

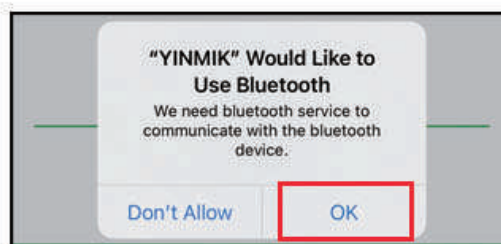
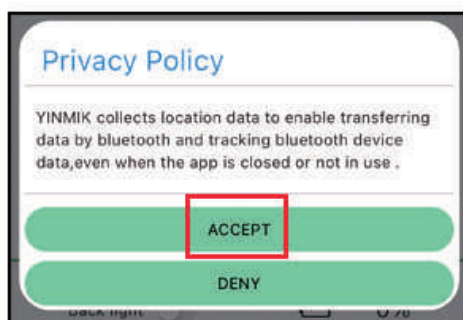

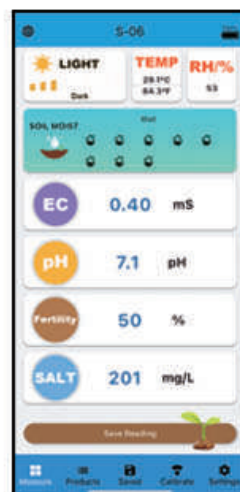

APP CONNECTION

- 1, Turn on the meter by pressing "ON/OFF". The red indicator light on the product is flashing.
- 2, Open the app and wait for automatic connection. APP will match the meter model automatically.
- 3, All testing results can be viewed on the APP. Model number display on top of the screen.
- 4, The product connection is successful, and the indicator light is off.



APP OPERATION

MEASURE

- 1, Click  can switch between Chinese and English.
- 2, Click  to save data Manually.
- 3, Click  to save measurement data.

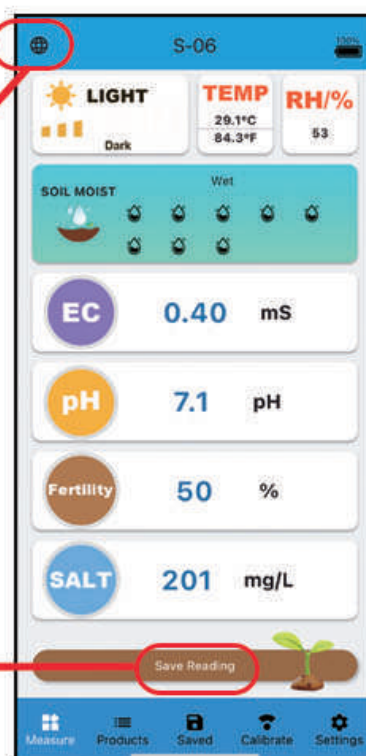
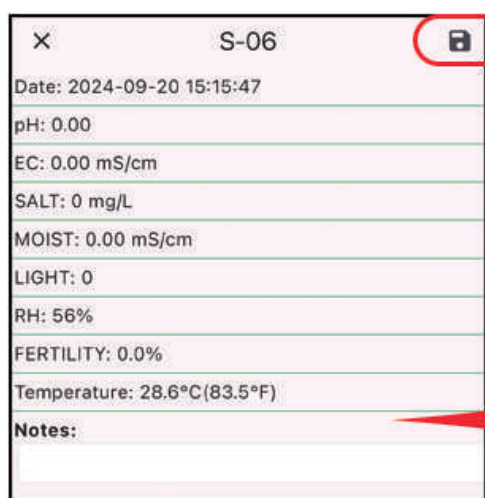

SAVED

1, Manually saved data is displayed in black.

2, Auto saved data is displayed in blue.

3, click  to share the file. If connect to the printer, the testing records can be printed.

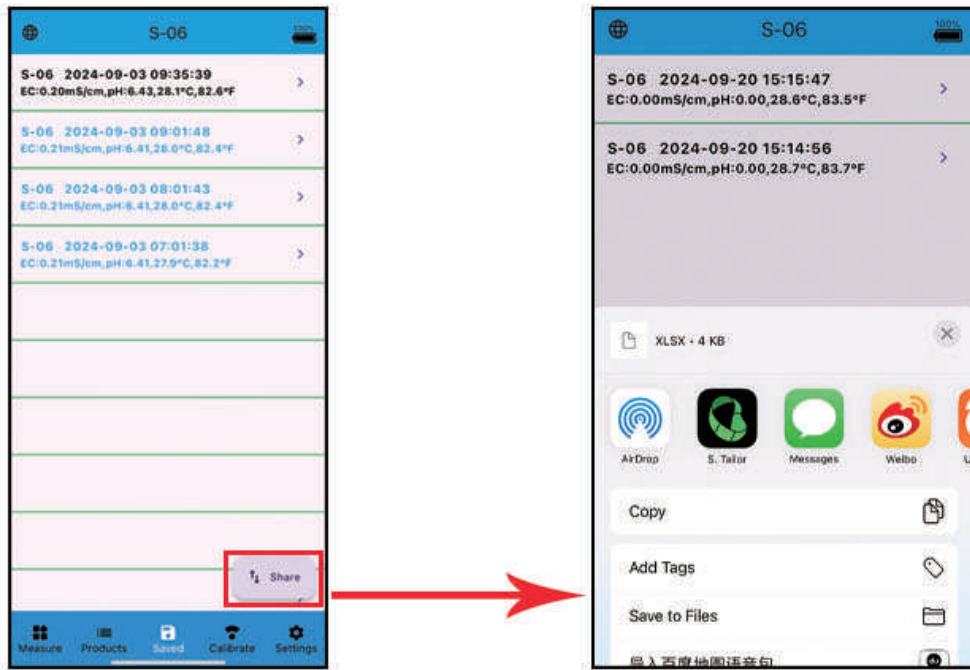

CALIBRATE

1, The pH calibration sequence is 7.0-4.0-10.0.

2, EC calibration uses 1413 μ S/cm calibration solution.

3, Please refer to the calibration introduction for specific calibration procedures. (Page 8).



SETTINGS

1, Click  to open auto save. Auto Saved time interval can be set (between 1-99 hours).

2, Set pH/EC Max or Min Limit values according to user's requirement. If testing results are out of range, the digits will display in red.

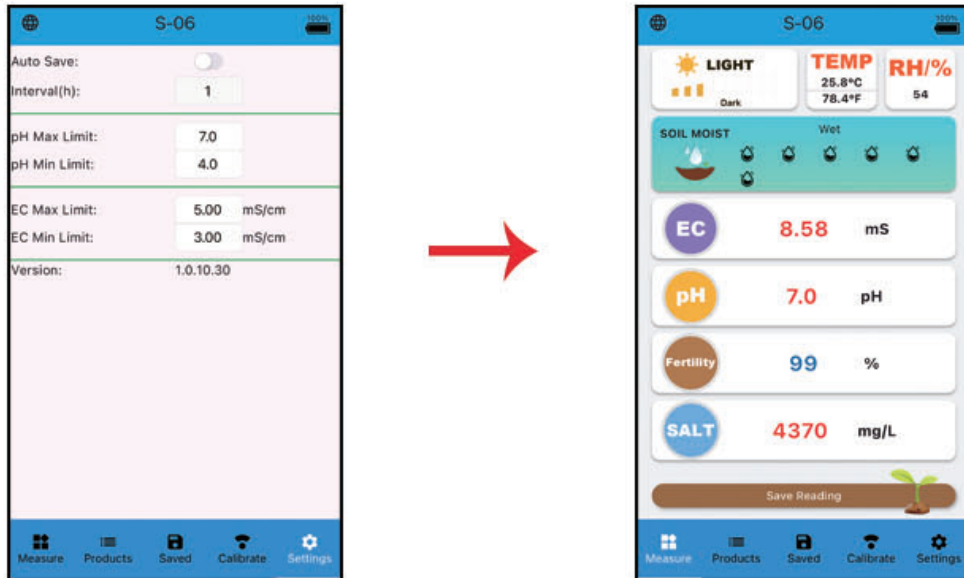

REPLACING THE BATTERY

1, The device battery level is displayed in the upper right corner of the APP homepage. Please replace the battery according to the battery level prompt.

2, Open the protective cover of the battery compartment, remove the old battery, and arrange 4 new batteries, paying attention to the placement of the positive and negative electrodes.

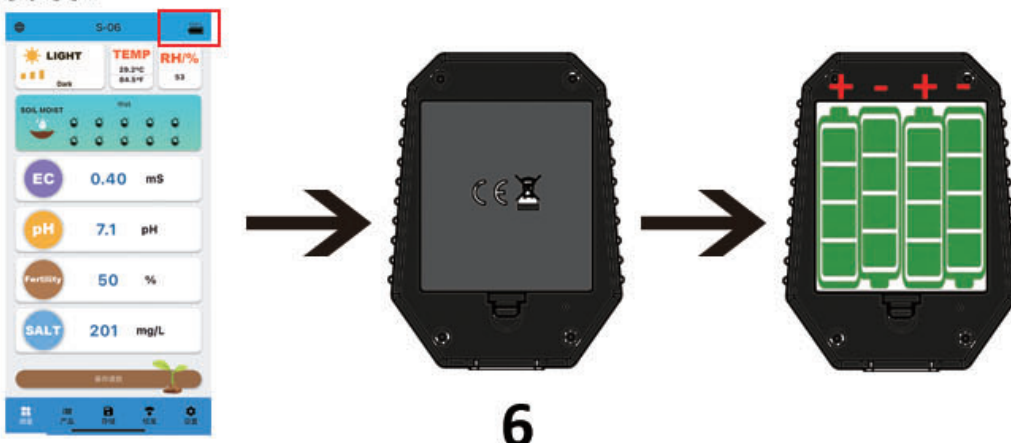

MEASUREMENT STEPS

1, Turn on the meter by pressing "ON/OFF". The red indicator light on the product is flashing.

2, Open the app and wait for automatic connection. APP will match the meter model automatically.

3, All testing results can be viewed on the APP. Model number display on top of the screen.

4, The product connection is successful, and the indicator light is off.

5, Slowly insert electrode into the soil, the insertion depth is at least 6cm. Make sure that the pH reference electrode (two white dots) is submerged in the soil.

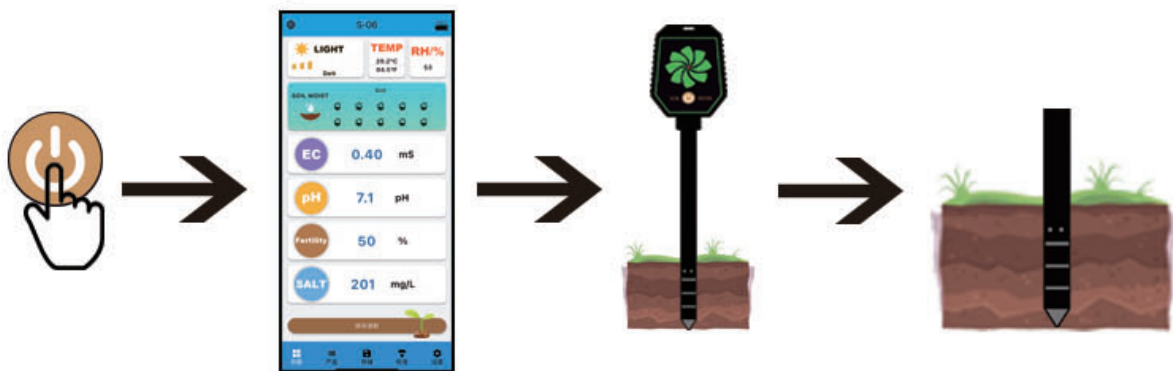

6, Pull out the electrode and wash the electrode with clean water. Use the brush to clean the residual soil on the electrode.

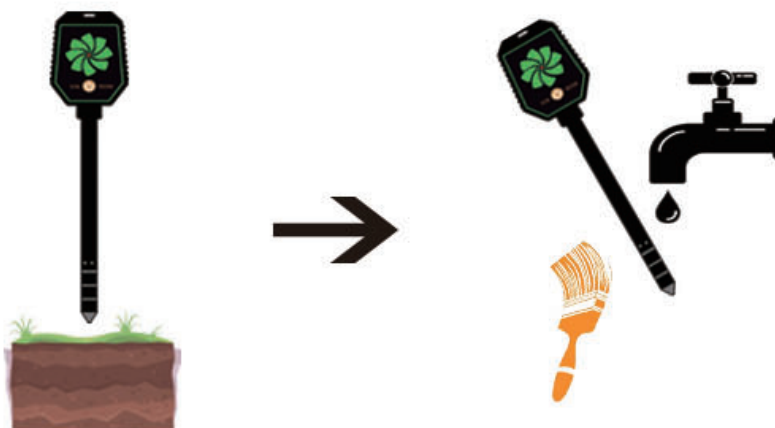

PH CALIBRATION

Tips:

1,PH Solution: Dissolve each buffersolution into 3 cups which is filled with250ml distilled water .

2,The calibration sequence is 7.0-4.0-10.0.

STEP 7.0

1,Turn on the meter by pressing "ON/OFF".Bluetooth connection to mobile app.

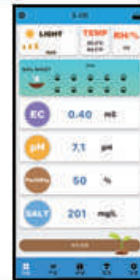

2, Put the pH probe into the pH7.0 buffer solution.Make sure that the pH reference electrode (two white dots) is submerged in the buffer solution.

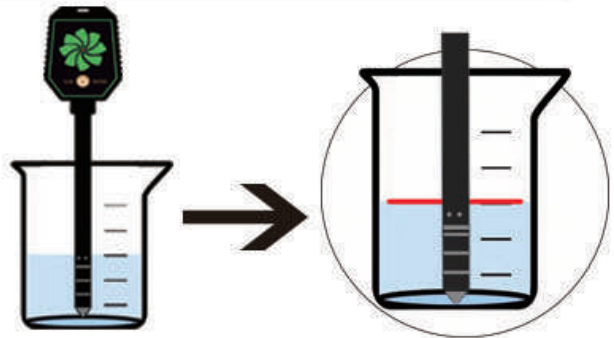

3, Wait for the screen value to stabilize and approach 7.0, then click on the calibration page and select pH calibration.

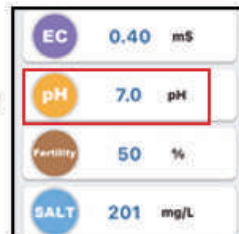

4,Click on "7.0" to calibrate, and the calibration record will be displayed after the calibration is completed.



5,Wash the electrode with pure water and wipe dry it.

STEP 4.0

1, Put the pH probe into the pH4.0 buffer solution. Make sure that the pH reference electrode (two white dots) is submerged in the buffer solution.

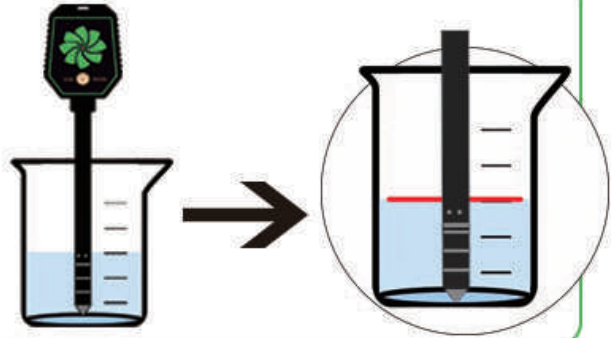

2, Wait for the screen value to stabilize and approach 4.0, then click on the calibration page and select pH calibration.

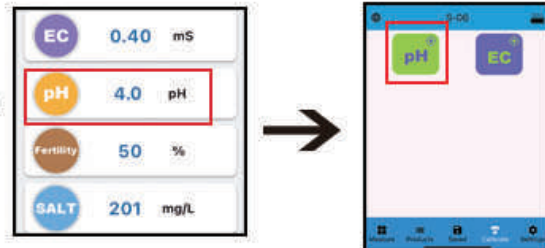

3, Click on "4.0" to calibrate, and the calibration record will be displayed after the calibration is completed.

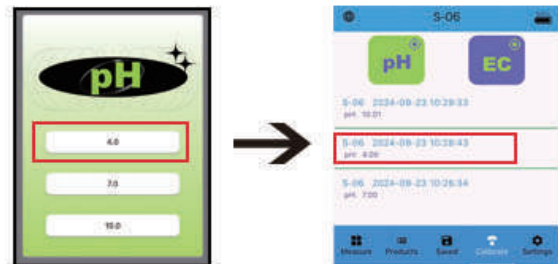

4, Wash the electrode with pure water and wipe dry it.

STEP 10.0

1, Put the pH probe into the pH10.0 buffer solution. Make sure that the pH reference electrode (two white dots) is submerged in the buffer solution.

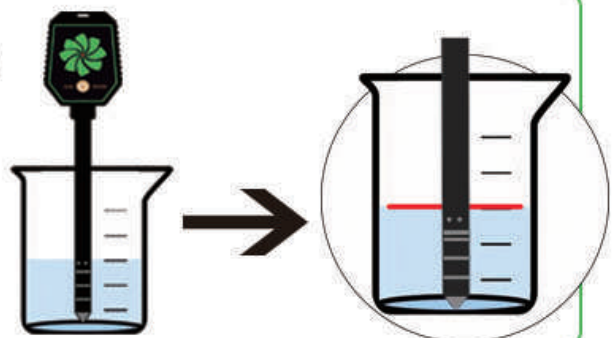

2, Wait for the screen value to stabilize and approach 10.0, then click on the calibration page and select pH calibration.

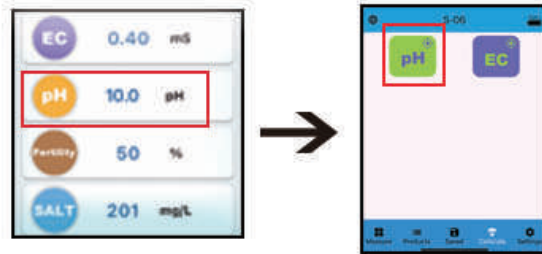

3, Click on "10.0" to calibrate, and the calibration record will be displayed after the calibration is completed.

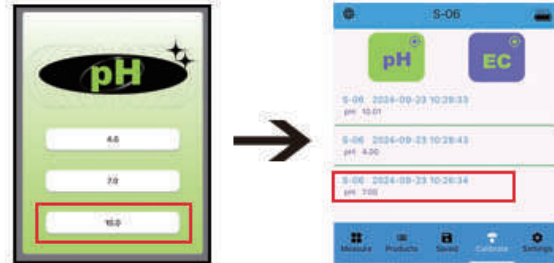

4, Wash the electrode with pure water and wipe dry it.

EC CALIBRATION

Tips:

- 1, The tester has been calibrated before leaving the factory, and there is no need for recalibration.
- 2, EC calibration requires 1413 μ S/cm calibration solution.

1, Turn on the meter by pressing "ON/OFF". Bluetooth connection to mobile app.



2, Put the pH probe into the 1413 μ S/cm buffer solution. Make sure that the pH reference electrode (two white dots) is submerged in the buffer solution.

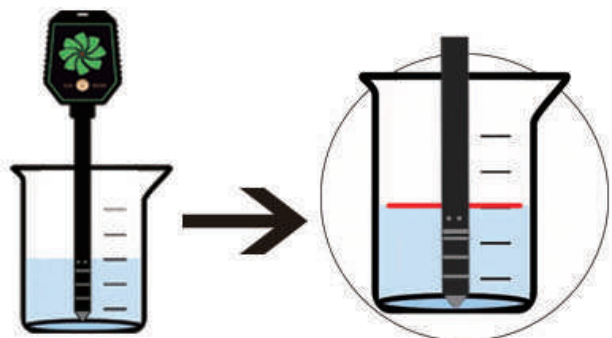

3, Wait for the screen value to stabilize and approach $1413\mu\text{S}/\text{cm}$, then click on the calibration page and select pH calibration.

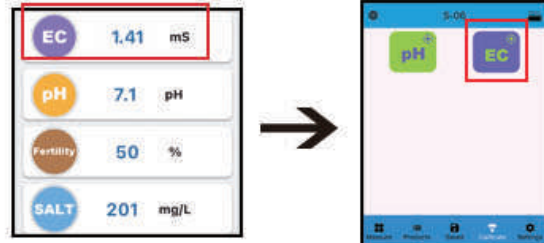

4, Click to enter 1.41, and the calibration record will be displayed after the calibration is completed.

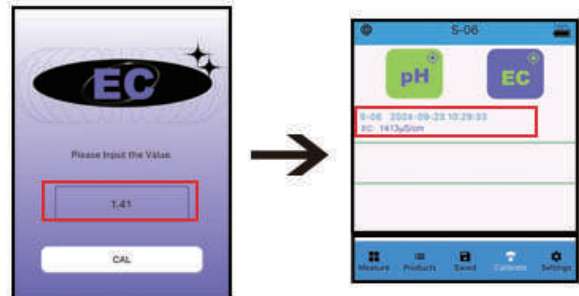

5, Wash the electrode with pure water and wipe dry it.