

This digital tachometer is designed to measure RPM, surface speed, and distance. It finds application in various industries, including electric power, steel, petrochemical, aviation, fan manufacturing, pipeline ventilation systems, underground warehouses, and other relevant scenarios.

#### SAFETY INFORMATION

To prevent eye damage and personal injury, please read all safety information carefully before using the product.

#### ⚠️ WARNING

- Please check the product before use. Do not use it if the product is damaged.
- Replace the batteries when the “” symbol is displayed to prevent incorrect measurements.
- Under the contact measurement model, it is easy to obtain a lower measurement value than the normal value due to insufficient friction if the rotating speed of the measured object is too fast.
- During contact measurement, ensure the stability of the ambient light source; otherwise, the measurement may fail.
- Do not use this product in environments with explosive gas, flammable vapor, and dust.
- To prevent battery leakage, remove the battery if the product is not used for an extended period or if stored in temperatures above 50°C.
- Only authorized technicians are permitted to repair this product.

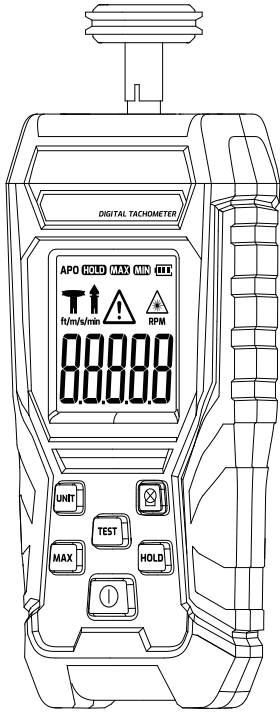

**SCAN THE QR CODE**  
to download the **USER MANUAL** in different languages and **SOFTWARE**



 **TUTORIAL VIDEO ON HOW TO USE**

 Need more help? **CONTACT US.** [www.cd50.net/401](http://www.cd50.net/401)

### PRODUCT OVERVIEW

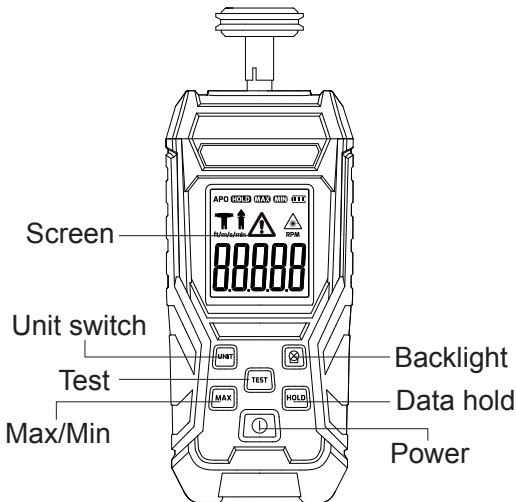

### TECHNICAL SPECIFICATIONS

Range	Non-contact type: 3~100000RPM Contact type: 3~19999RPM, 0~99999m 0~1999.9m/min, 0~9999.9ft/min
Accuracy	Non-contact type: ±(0.05%FS+1RPM) Contact type: ±(0.1%FS+1RPM)
Resolution	RPM: <10000: 0.1, RPM: ≥10000: 1 m: <10000: 0.1, m: ≥1000: 1 m/min: <2000: 0.1, ft/min: <1000: 0.1
Display	6 digits, max 99999
Effective measuring distance	50mm ~ 500mm
Sampling time	0.8s (above 60rpm)
Working environment	-10~50°C, max 80%RH, indoor altitude <2000m
Storage environment	-10~50°C, max 70%RH, (battery removed)
Product size	146 x 59 x 29mm
Screen size	34 x 31mm
Weight	Approx. 120g (battery not included)
Power	2 x 1.5V AAA (R03/LR03)

### DISPLAY

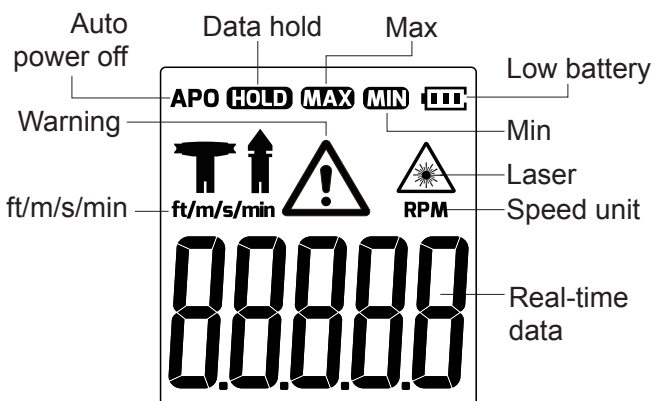

## OPERATION

### Probe Application 1

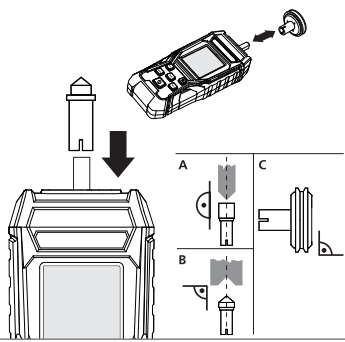

### Turn on and off the Meter 2

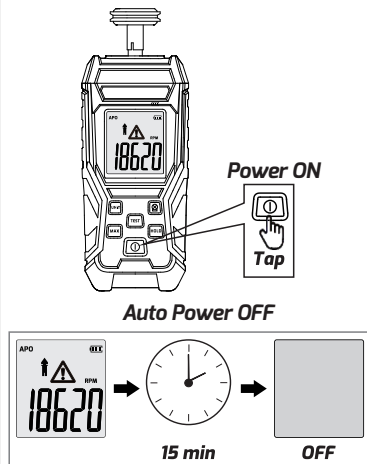

Please note that the device is set to automatically power off by default.

### Disable Auto Power Off 3

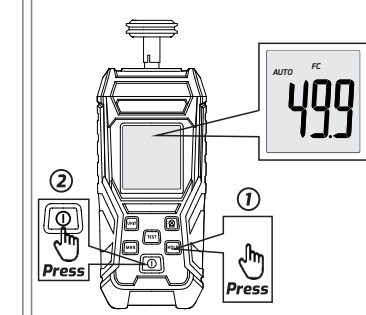

In the OFF status, press and hold "HOLD" button, then simultaneously press "Power ON" button until the APO icon disappears. After that, release both buttons.

### Non-contact type 4

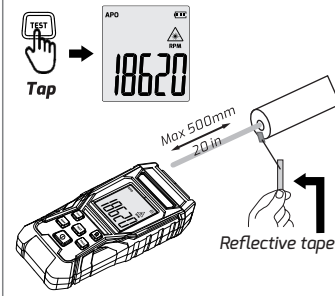

4

### Contact type 5

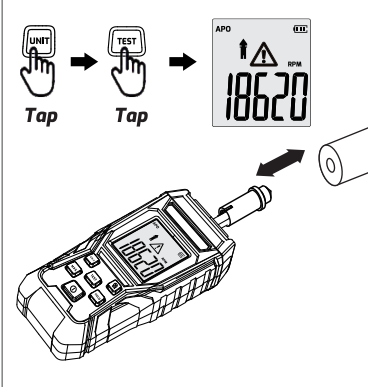

### Backlight 7

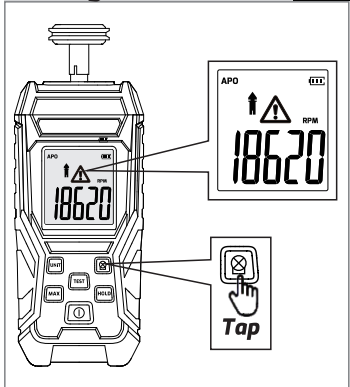

### Unit switch 6

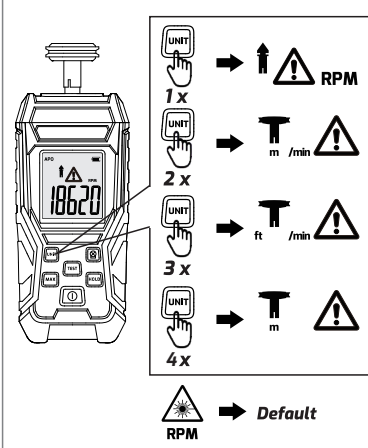

### Data hold 8

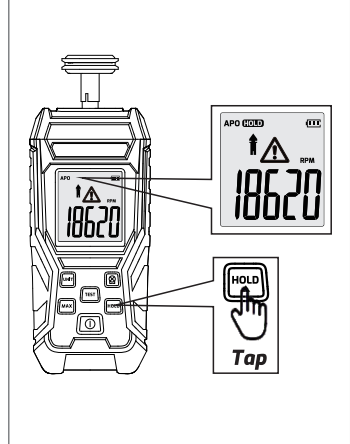

5

### Max/Min 9

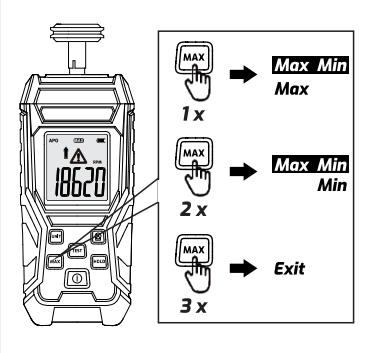

### Battery Replacement 10

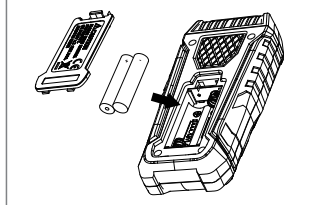

## WARRANTY

Each product is warranted in material and workmanship under normal use. The warranty period is one year and begins on the date of purchase.

To obtain warranty service, please contact the dealer or manufacturer to obtain return authorization information, then send the product to the service center.

6

7