

# WEATHER STATION

**3** OUTDOOR  
SENSORS



**SCAN THE QR CODE**



to download the  
**USER MANUAL**  
in different languages  
and **SOFTWARE**



**TUTORIAL VIDEO ON HOW TO USE**



Need more help? **CONTACT US.**



[www.cd50.net/288/](http://www.cd50.net/288/)

## CONTENTS

## Page

English .....	1 - 8
Features .....	1
Main Parts .....	1
LCD Full Display .....	2
Sensor Parts .....	3
Package Includes .....	3
Default Settings .....	4
Operations .....	4
Setting up the Main Unit .....	5
Installation .....	6
Detail Specifications .....	7
Safety Notes .....	8
Warning .....	8

## FEATURES

- Time display in English
- Time display as hour and minute
- Calendar in month and year from 2000 to 2099
- Hour in 12H/24H
- Temperature in °C/°F
- Three sensors displaying at the same time
- Indoor and Outdoor Temperature and Humidity
- Low battery display for monitor and sensors
- Max. and Min. indoor temperature and humidity
- Max. and Min. outdoor temperature and humidity
- Alarm and Snooze function
- LED black light

## MAIN PARTS

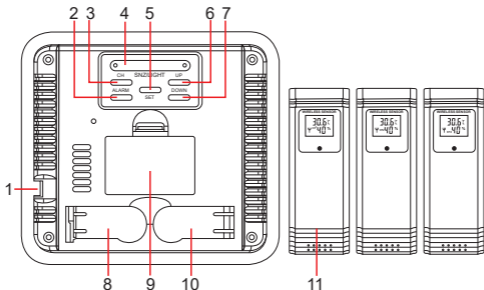

### 1. Power supply socket

It can be powered by the provided USB line or 3 pieces AAA batteries

### 2. Alarm button

For displaying / setting / deactivating / activating the alarm functions

### 3. CH button

For selecting the channel and re-registering the channels under normal mode

#### 4. SNZ/LIGHT button

For snoozing the alarm function while the alarm is ringing  
For turning-on the back light when powered by batteries only

#### 5. SET button

For setting date and time

#### 6. UP button

For adjusting the date and time in the setting mode and alarm mode  
For checking the maximum and minimum temperature and humidity of the past 24 hours  
Under Max/Min Mode, hold and press this button to clear the maximum/minimum values.

#### 7. DOWN button

For adjusting the date and time in the setting mode and alarm mode  
For switching Celsius or Fahrenheit unit

#### 8. & 10. Fold-out stand

#### 9. Battery compartment

#### 11. 3 Sensors

### LCD FULL DISPLAY

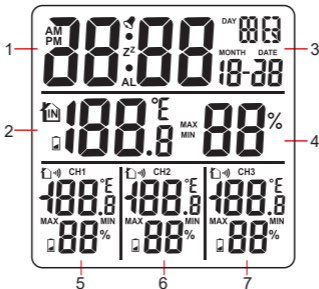

1. Time
2. Indoor temperature
3. Day of the week + date + calendar month
4. Indoor humidity
5. Outdoor temperature / outdoor humidity channel 1 (**CH1**),  
low battery level display for **sensor 1**
6. Outdoor temperature / outdoor humidity channel 2 (**CH2**),  
low battery level display for **sensor 2**
7. Outdoor temperature / outdoor humidity channel 3 (**CH3**),  
low battery level display for **sensor 3**

## SENSOR PARTS

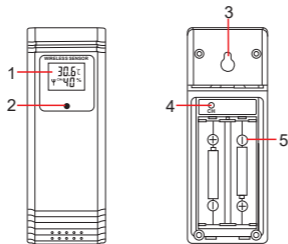

1. Display Outdoor temperature / Humidity / Low battery / Channel
2. Transmission indicator light
3. Recess for wall mounting
4. CH button - For selecting channel 1, 2 or 3
5. Battery compartment

## PACKAGE INCLUDES

- 1 x Base station for indoors
- 3 x Sensors for outdoors
- 1 x USB line for main power
- 1 x User manual

## DEFAULT SETTINGS

- a. Time: AM 00:00
- b. Date: Jan 1st, 2015
- c. Temperature °C
- d. Alarm function off

### NOTE:

This weather station will be reset when changing new batteries. A “BI” sound follows by the restarting of the weather station. The weather station will need two minutes to reconnect to the sensors.

## OPERATIONS

- a. It is suggested to set all the 3 sensors and channels before turning on the main unit.
- b. Insert the batteries with the correct polarity into the battery compartment and press “CH” button at the back of the sensors to set the channel 1, 2 and 3 accordingly.
- c. The channel number should appear at the left-hand-side of the humidity to indicate which channel is it using.
- d. Insert the USB line connector into the connection socket of the main unit or insert the batteries with the correct polarity into the battery compartment of main unit to turn it on.
- e. After turning on the main unit, it will automatically receive the signals from the sensors.
- f. It may take three minutes to warm up; all the data in the first three minutes may not be accurate.
- g. If the main unit cannot receive the signal after three minutes, you can press “CH” at the back of main unit to select a channel, and then press and hold “CH” at the back of main unit to re-register or take out the batteries and repeat the previous steps from a~ e.
- h. The sensors will be reset after changing new batteries. Please be reminded to go through the previous steps to set up the weather station again after changing the new batteries

**NOTE:**

1. If the  symbol is displayed on the sensor or main unit, please replace new batteries for them.
2. Backlight:
  - a. When you use the battery, press the “SNZ/LIGHT” button to light up the display for approximately 5 seconds.
  - b. When you use the USB line, the backlight will light up all the time.
  - c. **We recommend best using the original USB line for the main power supply and the battery for the backup power supply.**

## SETTING UP THE MAIN UNIT

### TIME SETTING

- a. Press “Set” to enter the time setting mode
- b. Press “Up” or “Down” button to adjust the time
- c. Press “Set” again to confirm the setting and go on for the next setting
- d. Setting order is year → month → day → hour → minute → 12/24HR → exit.
- e. Press SET to confirm setting and go on for next setting.
- f. Setting will be auto-saved once without any operation for 20 seconds

### ALARM SETTING

#### • Alarm time setting

- a. Press “Alarm” button to check the alarm time
- b. Press “Alarm” button again to turn on or off the alarm function
- c. Press and Hold “Alarm” button for about 4 seconds to enter the alarm setting mode
- d. Press “Up” and “Down” button to adjust the time
- e. Press “Alarm” button again to confirm the setting and go on to the next setting
- f. Setting order is hour → minute → exit.
- g. When the alarm is on, press “SNZ/LIGHT” button and it will repeat after five minutes.
- h. To “ Snooze” for another five minutes, press “SNZ/LIGHT” again when the alarm is on again.
- i. Press other keys to exit alarm status.
- j. Setting will be auto-saved once without any operation for 20 seconds

#### • Turning on / off alarm

- a. Press “Alarm” button to enter the alarm mode
- b. If the alarm function is switched on, there will be an alarm icon between the time

- c. The alarm will ring when the set time comes, starting with
  - BI sounds for 1st – 10th seconds
  - BIBI sounds for 11st – 20th seconds
  - BIBIBI sounds for 21st – 30th seconds
  - BIBIBI... sounds for 31st seconds – 2 minutes
- d. Press “SNZ/LIGHT” button to snooze, the alarm will ring again after 5 minutes
- e. Press any other key than the “SNZ/LIGHT” to turn off the alarm

## INSTALLATION

- a. Only install the main unit & sensors once the appropriate settings have been made and a stable wireless connection is established.
- b. Please refer to the setting up the main unit part for the main unit settings.
- c. The wireless transmission range between the sensor and main unit is up to 30M in open spaces.
- d. Before installation, ensure that wireless transmission will not be disrupted by interference or obstacles like buildings, trees, vehicles, high-voltage lines, etc.
- e. Before the final installation, ensure that there is sufficient reception between the intended installation locations.
- f. When installing the sensor, ensure that it is protected from direct sunlight and rain.
- g. The international standard height for measuring air temperature is 1.25 m (4 ft) above ground.
- h. Buy special or suitable installation material from a specialized dealer for wall-mounting.
- i. Ensure that no faulty or damaged parts are installed.
- j. Never apply force during installation. This could damage the product.
- k. Before installation, ensure that the chosen wall is suitable for the weight to be mounted, and make sure that there are no electrical wires, water, gas or other lines at the installation site on the wall.

## DETAIL SPECIFICATIONS

### INDOOR TEMPERATURE (MAIN UNIT)

Operating Range	0°C ~ 50°C (32°F ~ 122°F)
Measure range	0°C ~ 50°C (32°F ~ 122°F)
Accuracy	0°C ~ +50°C: ±1°C (32°F ~ 122°F: ±1.8°F)
Resolution	1°C or 1°F
Temperature Cycle	One minute

#### NOTE:

If the operating area is higher than the range, the temperature will display “HI”  
If the operating area is lower than the range, the temperature will display “LO”

### OUTDOOR TEMPERATURE (SENSORS)

Operating temp. Range	-40°C ~ 70°C (-40°F ~ 158°F)
Measure range	-40°C ~ 70°C (-40°F ~ 158°F)
Accuracy	-40°C ~ -20°C: ± 4°C (-40°F ~ -4°F: ±7.2°F); -20°C ~ 0°C: ± 2°C (-4°F ~ 32°F: ±3.6°F); 0°C ~ +50°C: ±1°C (32°F ~ 122°F: ±1.8°F)
Resolution	1°C or 1°F
Temperature Cycle	30 seconds

#### NOTE:

If the operating area is higher than the range, the temperature will display “HI”  
If the operating area is lower than the range, the temperature will display “LO”

### INDOOR/OUTDOOR HUMIDITY (MAIN UNIT AND SENSORS)

Operating humidity range	20% RH ~ 95%RH ± 5% RH (@25°C, 30%RH ~ 80%RH)
Accuracy	± 8% RH (@25°C, 20%RH ~ 29%RH; 80%RH ~ 95%RH)
Resolution	1% RH

## SAFETY NOTES

- a. The product is intended for private, non-commercial use only.
- b. Do not operate the product outside the power limits given in the specifications.
- c. Do not use the product in moist environments and avoid splashes.
- d. Do not use the product in the immediate vicinity of heaters or other heat sources or in direct sunlight.
- e. Do not use the product in areas where the use of electronic devices is not permitted.
- f. Do not use the product near interference fields, metal frames, computers, TVs, etc. Electronic devices and window frames can negatively affect the product's functionality.
- g. Do not drop the product and do not expose it to any major shocks.
- h. Do not open the device or continue to operate it if it becomes damaged.
- i. Do not attempt to service or repair the product yourself. Leave any and all service work to qualified experts.
- j. Keep the packaging material out of the reach of children due to the risk of suffocation.
- k. Do not modify the product in any way. Doing so voids the warranty.

## WARNING - BATTERIES AND USB LINES

- a. Immediately remove and dispose of dead batteries from the product.
- b. Only use batteries (or rechargeable batteries) that match the specified type.
- c. Do not mix old and new batteries or batteries of a different type or make.
- d. When inserting batteries, note the correct polarity (+ and - markings) and insert the batteries accordingly. Failure to do so could result in the batteries leaking or exploding.
- e. Do not charge batteries.
- f. Keep batteries out of the reach of children.
- g. Do not short circuit the batteries/rechargeable batteries and keep them away from uncoated metal objects.
- h. **The batteries is only used for backup power supply, please use the provided USB line for the main power supply.**